



# "The easy way to Plug&Play" with Ventus automated hardware range.

Ventus Automated hardware provides a complete range of automated window hardware for Residential and Commercial applications.

The range consists of Automated Chainwinders suitable for use with awning windows and motorised Auto Louvre Galleries, packaged into an easy to install system that does not require an electrician to wire. The 'Plug & Play' system runs on a 24V DC power supply for simplicity, reliability and ease of connection.

Suiting a variety of applications Ventus Automated hardware can be used in floor to ceiling systems as well as those hard to reach areas.

## PLUG&PLAY SYSTEM

The Ventus 'Plug & Play' system features a range of controllers, switches and motors all connectable via quick connect plugs adding speed and ease to installation.

The 'Plug & Play' system offers control for up to eight windows and capable of operating the window operator motors all at the same time.

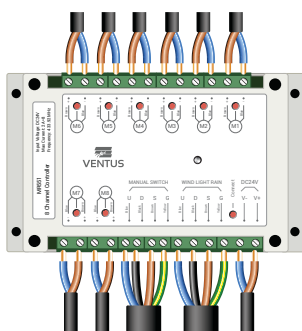

**MR551**  
8 Channel Controller

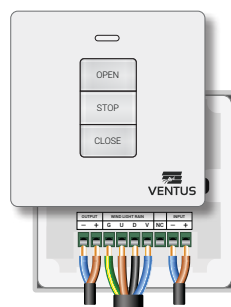

**MR536**  
1 Channel Controller



**2 Pin Plugs**  
Power and Motors



**4 Pin Plugs**  
Accessories

## REMOTES & CONTROLS

One controller can be connected to an infinite number of switches and remotes, allowing you to put the controls where you want for absolute convenience.

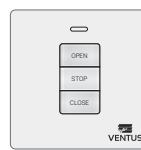

**WT211**  
1-Channel  
wireless  
wall mounted  
switch

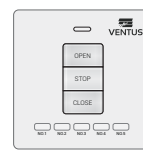

**WT215**  
5-Channel  
wireless  
wall mounted  
switch



**RT111**  
1-Channel  
wireless  
remote  
control



**RT1116**  
16-Channel  
wireless  
remote  
control

## POWER SUPPLY

Running on 24V DC, the system by design only requires a GPO or regular mains power outlet at the reach of the supplied power pack to plug into. A key benefit the Ventus 'Plug & Play' system offers is no need for an electrician to wire up the hardware components.



**2.5A Power Pack**

**10A Power Pack**

## AUTOMATED CONTROLS

A Wind Light Rain Sensor can be added to offer an automatic control when the weather turns undesirable. The system also alternatively allows to connect into the existing Building Management System (BMS) or C-BUS.



**WLR001**  
Wind, Light, Rain Sensor

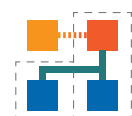

**BMS &  
C-BUS  
Integration**



## WINDOW OPERATORS

Ventus Auto Hardware range provides a host of motor options. The choice is simply down to the type and size of the window be it a Ventus Louvre Gallery or electric chainwinders for awning or casement windows.



**WATCH OUR VIDEO:**  
**VENTUS AUTOMATED HARDWARE**

 **YouTube**  **Alchin Long Group**

### AUTO LOUVRE GALLERIES



Ventus Auto Louvre Galleries are a complete window solution, offering the frame, louvre blades and motorisation, all complete ready for on-site installation.

### AUTO CHAINWINDERS



Auto Chainwinders are a great option for new and existing awning and casement windows. Most window sizes are covered thanks to a range of motor options to choose from.



# AUTO HARDWARE COMPONENTS

All the hardware you need and no confusion. The Ventus range encompasses control units at the heart of the system, power supply, control pads and wireless remotes, automated sensors, leads, extensions, accessories and the window operator motors themselves. Comprehensive wiring diagrams to aid in the 'Plug & Play' installation is also available.

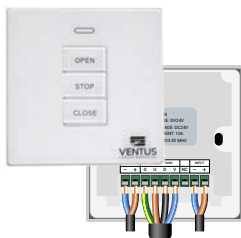

**MR536**

1-Channel control unit



**MR551**

8-Channel control unit



**POWER PACK 2.5AMP**

Mains power 240V AC  
to 24V DC



**POWER PACK 10AMP**

Mains power 240V AC  
to 24V DC



**21UP2403**

UPS battery backup power

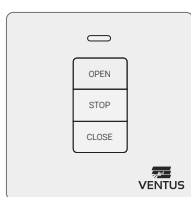

**MS541**

Wired wall mounted  
switch



**RT111**

1-Channel wireless  
remote control



**RT1116**

16-Channel wireless  
remote control

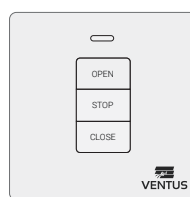

**WT211**

1-Channel wireless  
wall mounted switch

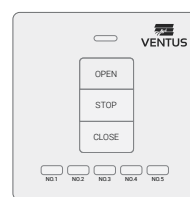

**WT215**

5-Channel wireless  
wall mounted switch



**WLR001**

Wind Light Rain Sensor



**C2075F01**

2-Core female plug 100mm



**C2075M01**

2-Core male plug 100mm



**C2075F3**

2-Core female plug 3m



**C2075M3**

2-Core male plug 3m



**C2075FM3**

2-Core female-male plug 3m



**C2075FM10**

2-Core female-male plug 10m



**C2075M10**

2-Core male plug 10m



**C405F3**

4-Core female plug 3m



**C405M3**

4-Core male plug 3m



**C405FM3**

4-Core female-male plug 3m



**S102P**

Chainwinder SYNC Lead



**C1F2M TEST LEAD**

On-site test unit



**Louvre OCP**

Over Current Protection  
\*Included with Auto Louvre



**Auto Louvre  
102mm Blade**



**Auto Louvre  
152mm Blade**



**SCE100s**

Electric Winder 100mm chain



**SCE300s**

Electric Winder 300mm chain



**LCD300**

Electric Winder - 300mm chain



**TCE300**

Twin chain electric winder - 300mm chain

# QUICK LAYOUT GUIDE

## 1 CHANNEL LAYOUT

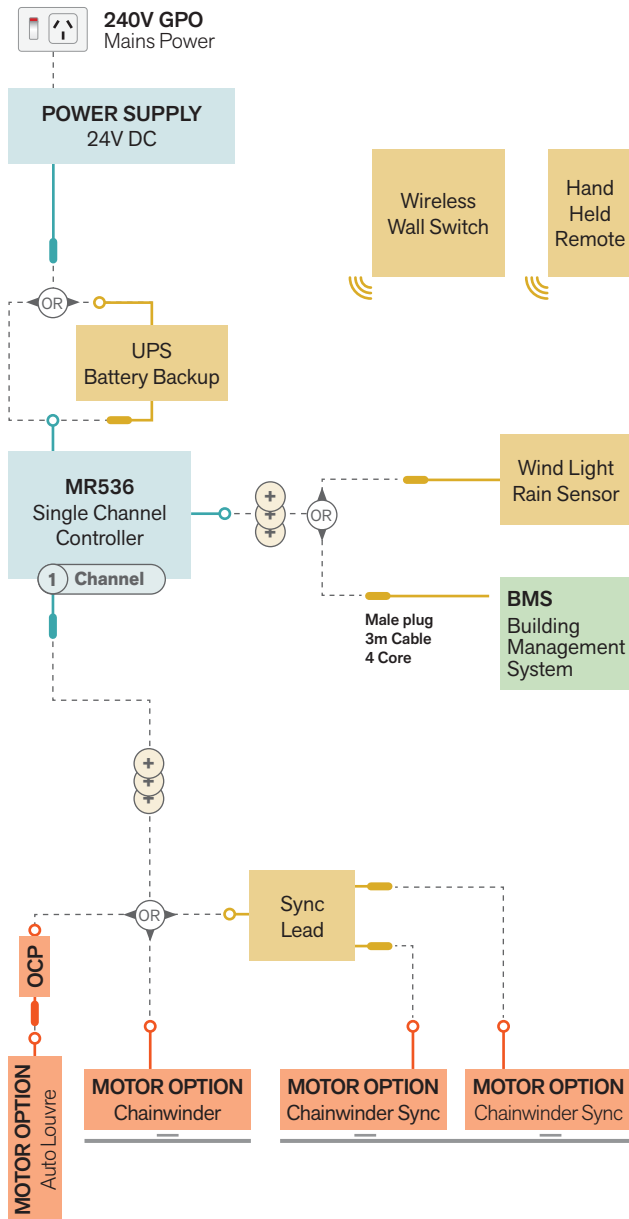

## 8 CHANNEL LAYOUT

(UP TO 8 WINDOWS FROM ONE CONTROLLER)

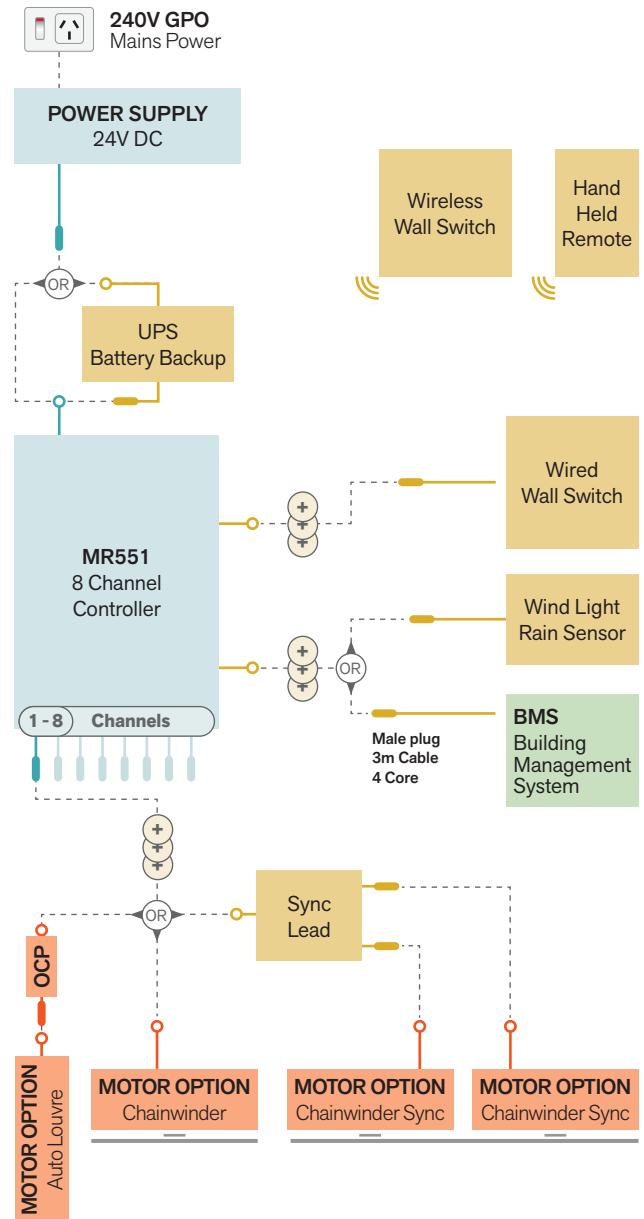

### SELECTION REQUIREMENTS:

<b>BASE/MINIMUM</b>	For the system to work, these are the base required hardware.
<b>EXTENSION OPTIONS</b>	These items are added if required.
<b>MOTOR OPTION</b>	Your selected automated window motor option.

- ADDITIONAL 'PLUG & PLAY' EXTENSION LEADS AVAILABLE**
- EITHER/OR OPTION**
- AVAILABLE CHANNELS**  
Repeat wiring per channel as required

### IMPORTANT:

- System and Motors operate on 24V DC

**1-4 Motors** require  
2.5amp Power Pack

**5+ Motors** require  
10amp Power Pack

*Note: TCE300 Twin Chainwinder uses two motors.*

- Repeat wiring for each channel/window as required
- For Sync'd Chainwinders, utilise channels 1, 3, 5, 7
- TCE300 Twin Chainwinder **not available** for Sync
- Comprehensive electrical drawings and component lists are available on the website.



## VENTUS | AUTOMATED LOUVRE GALLERIES

Though louvre design has changed a great deal since their early days, one thing has remained constant... louvres are the only window system that gives you a

### 100% OPENING ADVANTAGE

This means louvres are the most practical window system when it comes to taking advantage of breezes and natural ventilation by providing a 100% opening advantage. Louvres offer the least resistance to air flow. Open them for the full breeze effect, tilt them for ventilation even on a rainy day, or simply close them to seal the home and protect it from elements.

Louvres practicality means that they can be used anywhere or better yet, everywhere. Use louvres to open up a room or the entire house to fresh air and cool breezes. Cooling and ventilating your home with fresh, natural breezes is not only healthy, but also energy efficient.

### VENTUS LOUVRE GALLERIES

Modern attractive louvre blade clip, concealed motor and performance tested beyond the Australian Standard requirements, the Ventus Louvre Galleries are an outstanding choice for homes and commercial premises across Australia made easier with 'Plug & Play'

The louvre clips have been designed and manufactured to hold 6mm toughened or float blade glass with a maximum length of up to 950mm in both 102mm and 152mm blade lengths.



### COLOUR OPTIONS

(Gallery Channel and Blade Clips only, excludes glass)



SATIN  
BLACK



SILVER

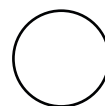

PEARL  
WHITE



CUSTOM  
COLOURS  
AVAILABLE



## IT'S ALL IN THE NAME

- V**ent, the 100% opening advantage
- E**lectric automated control
- N**on-Scratch UV stabilised powder coat
- T**ested to meet AS4420 test methods and passed AS/NZS2047-2014
- U**V stabilised state-of-the-art polymer components
- S**leek and elegant design when opened and closed

## FEATURES

- Made from non-toxic, environmentally friendly, UV stabilised, non-corrosive and resilient materials
- Window restriction compliant
- Tested, passed and certified under the most stringent Australian tests
- 2 Year warranty on Automated Hardware
- Wireless control available

## ADVANTAGES

- Energy efficient louvre windows for maximum energy savings
- Highest performing standard louvre product in Australia
- Offset clips allow clearance of screens when installed in commercial main frame



When installed according to installation instructions

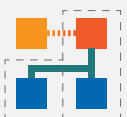

OPERATES ON ALL  
**BMS & C-BUS**



**C TICK Certified**

## BLADE SIZES

Ventus Louvres are available in two sizes, 152mm blade and 102mm blade. These sizes offer a different aesthetic whilst offering the same ventilation characteristics. Both are suitable for insect or security screening and allow the blades to be fully opened.

### 102mm Series



### 152mm Series

The 152mm blade clip features a exclusive pivot location that offsets the glass internally to the inside of the building so standard commercial frames can be used. This features means the same frame can be used on both windows and doors.



### GLASS SPECIFICATIONS:

(Glass Blades not included)

Thickness:	6mm
Glass Type:	Toughened or float blade glass
Max Length:	950mm

# GALLERY HEIGHTS & MOTOR LOCATION

## VENTUS LOUVRE GALLERY 102mm AUTO

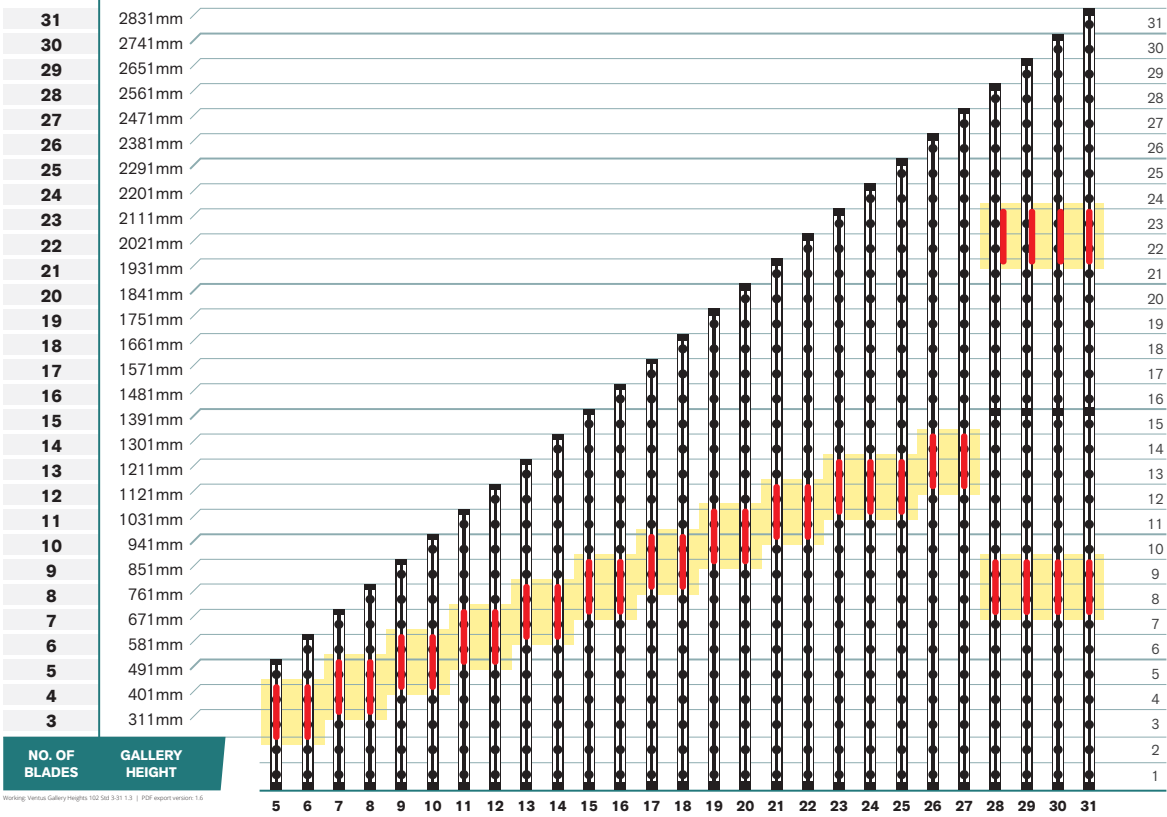

## VENTUS LOUVRE GALLERY 152mm AUTO

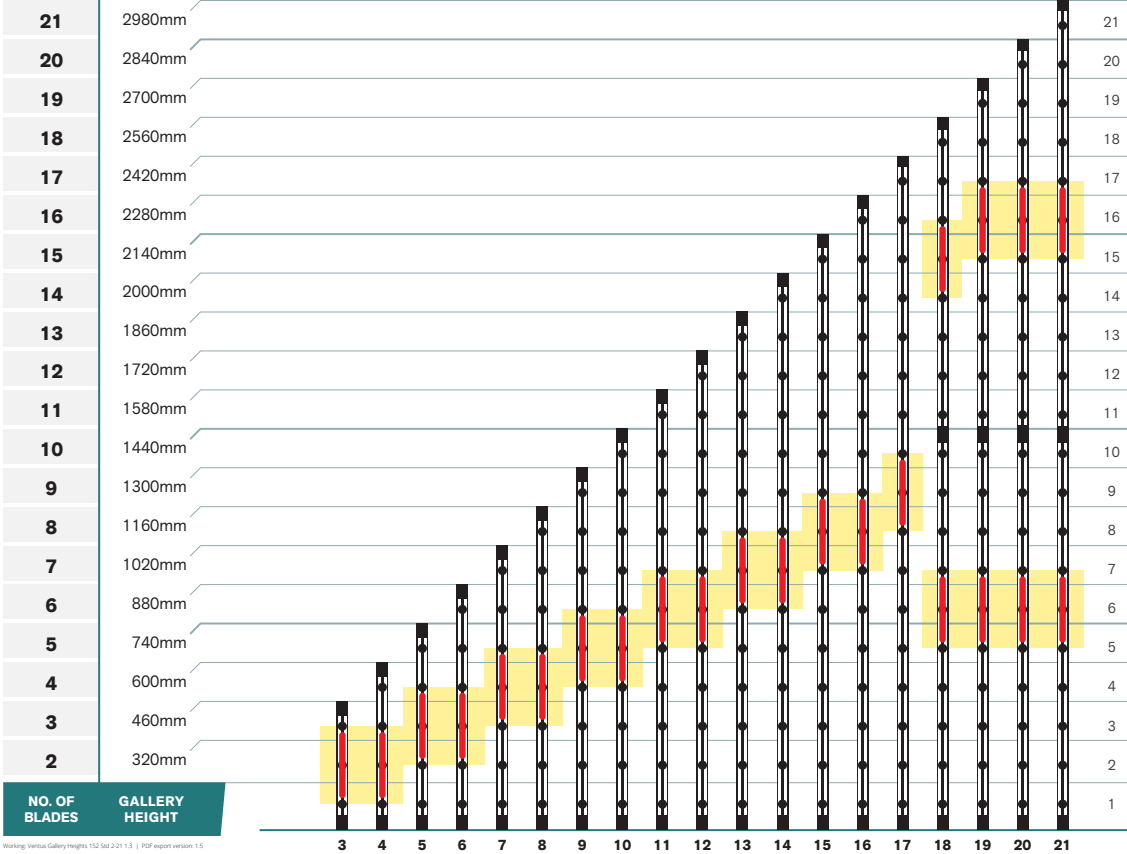

**MOTOR LOCATION**

**Note:**  
Heights greater than the heights displayed are possible as engineered solutions



# AUTO LOUVRE & OCP

An OCP (Over Current Protection) is a device that plugs in line directly to the Auto Louvre motor offering protection from damage.

In part owing to the louvre motors compact design and needing to fit within the gallery frame, the OCP is a separate device. It is recommended to be installed in the cavity or ceiling space next to the Control Box (controller) making it easier to access, troubleshooting faults, or swapping out a damaged unit.

The OCP operates like a fuse, designed to be a last line of defense to stop over current surges and spikes from reaching the motor. In the event this happens, the motor will temporarily not work until the OCP is replaced. The great advantage in protecting it like this avoids requiring extensive disassembly of the glass and galleries to access the motor for replacement. It's a matter of unplug and reinstall the OCP by the controller.

Every Auto Louvre motor requires a Over Current Protection (OCP) and one is supplied with every motor.

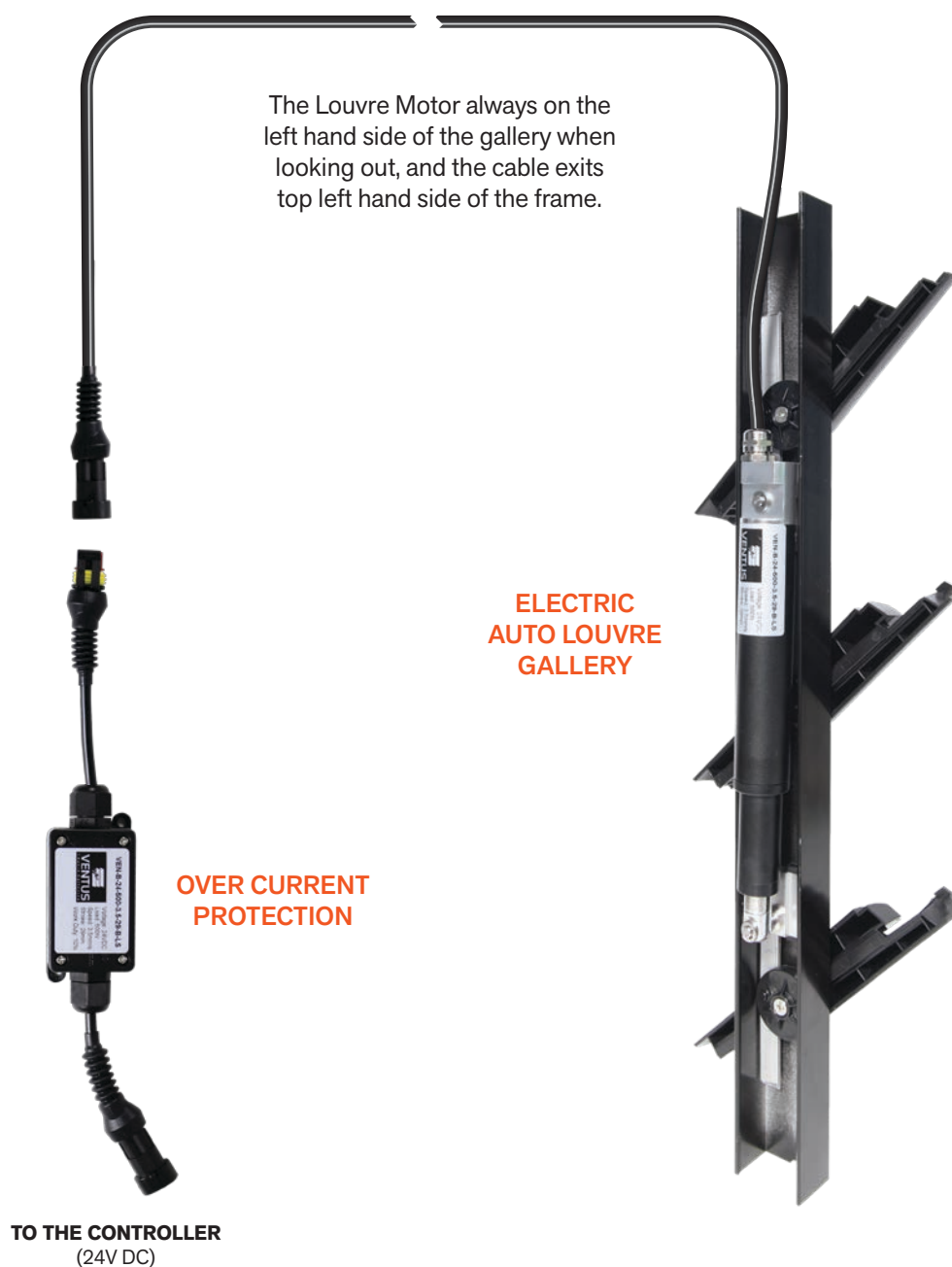



## VENTUS | AUTOMATED CHAINWINDERS

A Ventus Electric Chainwinder is a great option for both existing and new awning windows with the majority of window sizes covered. From small to medium windows using the SCE300s in most residential applications, and LCD300 and TCE300 for the larger commercial installations. For compliance with Fall Prevention and 'Kids Don't Fly' requirements, the short 100mm chain is available with the SCE100s for safety and peace of mind.

### COLOUR OPTIONS

(Body colour only, excludes chain, cable & brackets)



CLEAR  
ANODISED



SATIN  
BLACK

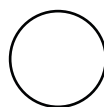

PEARL  
WHITE



CUSTOM  
COLOURS  
AVAILABLE

### TESTING



Performance tested to 30,000 cycles

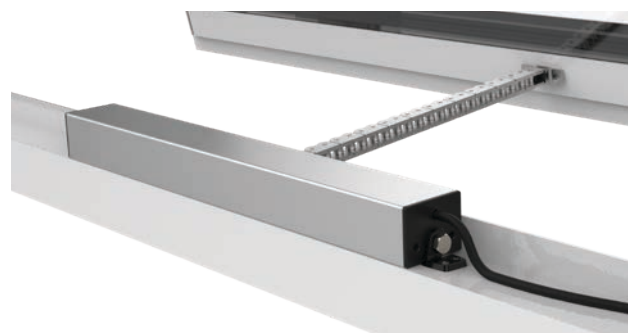

**IP32  
RATED**

When installed according  
to installation instructions



**OPERATES ON ALL  
BMS & C-BUS**



**C TICK Certified**

# VENTUS | AUTOMATED CHAINWINDERS



	SCE100S SHORT SINGLE	SCE300S SMALL SINGLE	LCD300 LARGE SINGLE	TCE300 LARGE TWIN
<b>VOLTAGE</b>	24V DC	24V DC	24V DC	24V DC
<b>PUSH/PULL FORCE</b>	250N	250N	400N	800N
<b>CHAIN PROJECTION</b>	100mm	300mm	300mm	300mm
<b>WINDOW HEIGHT (MAX.)</b>	1500mm	1500mm	1800mm	1800mm
<b>WINDOW WIDTH (MAX.)</b>	1200mm	1200mm	1200mm	2400mm
<b>SASH WEIGHT (MAX.)</b>	< 25kg	< 25kg	< 40kg	< 80kg
<b>CHAIN</b>	304 Stainless Steel	304 Stainless Steel	304 Stainless Steel	304 Stainless Steel
<b>SYNC</b>	SCE100S+SCE100S	SCE300S+SCE300S	LCD300+LCD300	
<b>PUSH/PULL FORCE</b>	500N	500N	800N	
<b>WINDOW HEIGHT (MAX.)</b>	1200mm	1200mm	1500mm	
<b>WINDOW WIDTH (MAX.)</b>	2400mm	2400mm	2400mm	
<b>SASH WEIGHT (MAX.)</b>	< 50kgs	< 50kgs	< 80kgs	

**SYNCHRONISED** refers to the addition of a synchroniser box plugged from a channel on the control box and operates two matching Automated Chainwinders through one channel simultaneously.

## IMPORTANT:

Automated Chainwinders are to be used with **Non-Friction Stays**. Friction Stays should not be used.

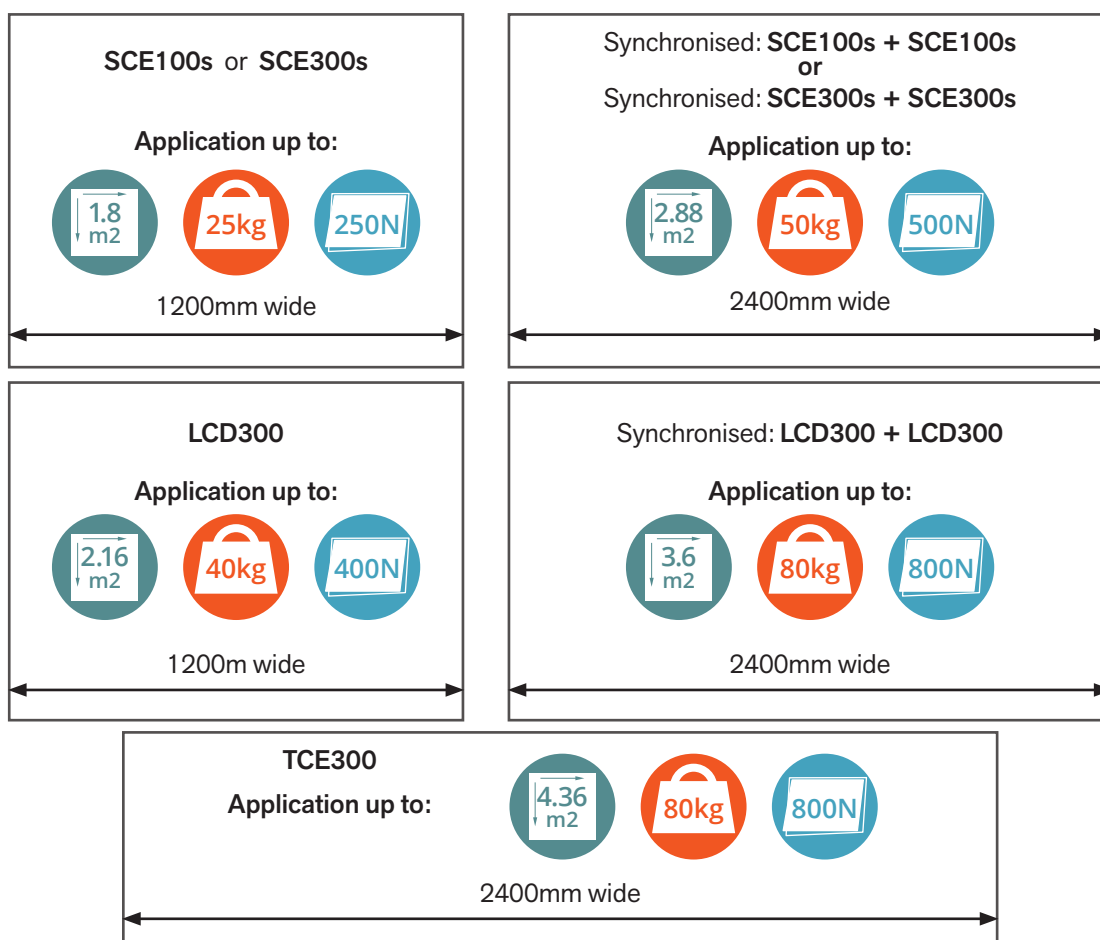



# VENTUS | AUTOMATED CHAINWINDERS



## WIRELESS CONTROL

Wireless Hand Held Remote and Wireless Wall Switch offers control from convenient locations and is easily paired to the Plug&Play Controller Unit.

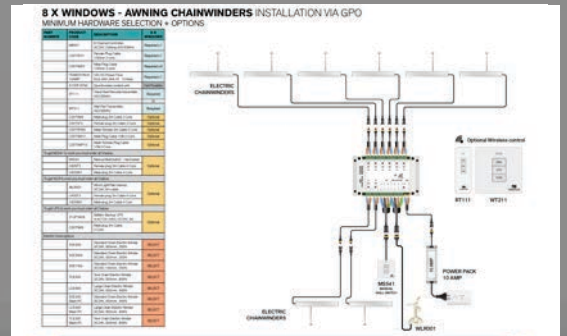

## EASY TO FOLLOW COLOUR CHARTS

Installation is made a breeze with the easy to follow colour chart and wiring drawings.



## QUICK CONNECT PLUGS

The Ventus system connects fast and simple by the use of quick connect plugs.



## NO ELECTRICIAN WIRING

Using quick connect plugs and a 24V DC power pack plugging into a general power outlet (GPO), the system does not require a licensed electrician to connect all the components.

# The easy way to **PLUG&PLAY**



## LEFT OR RIGHT CABLE SIDED

The removable end caps enable the body to flip over providing the cable to be either on the left or right hand side of the winder body.



## 100mm & 300mm CHAIN STROKE

To help aid against child fall prevention and compliance, Auto Chainwinders offer 100mm & 300mm stroke to limit the openings.

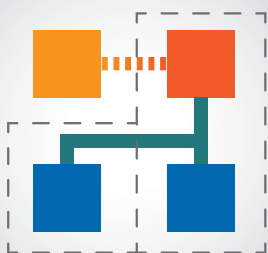
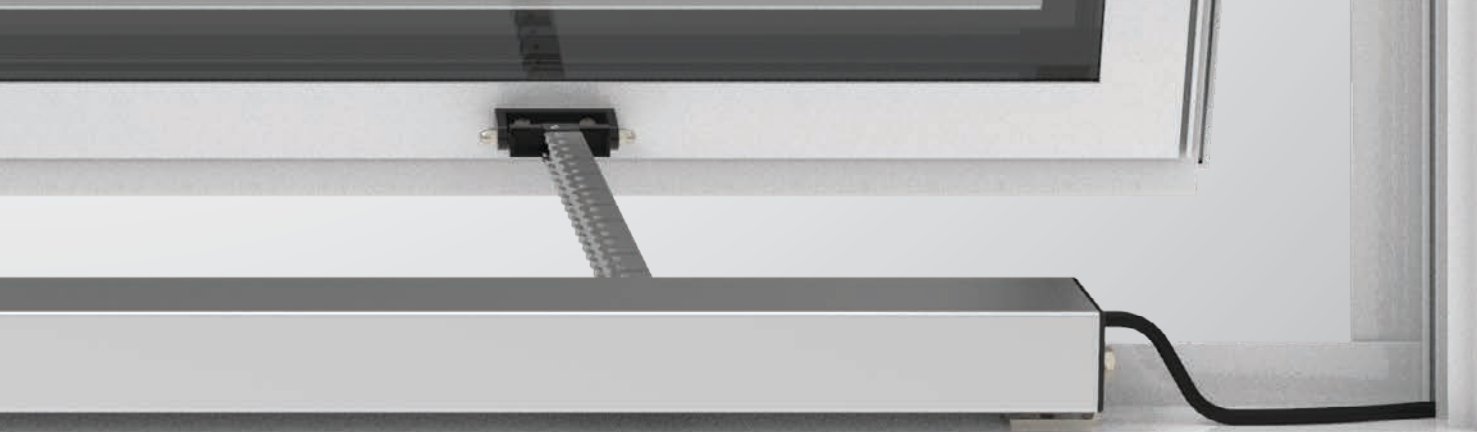

## MULTIPLE INSTALLATION OPTIONS

The system can operate either standalone or integrate with BMS, C-BUS, & GPO installations, adding for flexibility of control and installation.

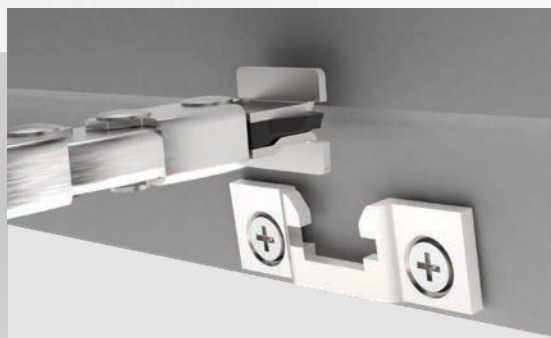

## EASY LINK SASH PLATE

Attaching the sash chain is fast and easy with the Easy Link Sash Plate. Mount the plate brackets and clip-lock in the sash chain. Available with SCE300s & SCE100s only.



## SCE100S | SHORT SINGLE ELECTRIC CHAINWINDER

### PRODUCT DETAILS

<b>VOLTAGE</b>	24V DC
<b>PUSH/PULL FORCE</b>	250N
<b>CHAIN PROJECTION</b>	100mm
<b>WINDOW HEIGHT (MAX.)</b>	1500mm
<b>WINDOW WIDTH (MIN - MAX.)</b>	350mm - 1200mm
<b>CHAIN</b>	304 Stainless Steel
<b>CODE</b>	9052637 - SCE100S

The Ventus SCE100s features a short 100mm chain projection. It is best suited for small and light weight awning windows up to 1200mm wide by 1500mm high. Capable of producing 250N of force, the electric chainwinder can operate a window up to 25kg in weight.

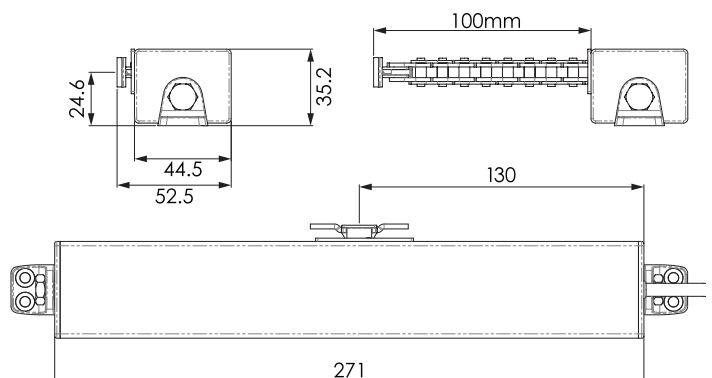





## SCE300S | SMALL SINGLE ELECTRIC CHAINWINDER

PRODUCT DETAILS	
<b>VOLTAGE</b>	24V DC
<b>PUSH/PULL FORCE</b>	250N
<b>CHAIN PROJECTION</b>	300mm
<b>WINDOW HEIGHT (MAX.)</b>	1500mm
<b>WINDOW WIDTH (MIN - MAX.)</b>	350mm - 1200mm
<b>CHAIN</b>	304 Stainless Steel
<b>CODE</b>	9052809 - SCE300S

The Ventus SCE300s offers a chain projection up to 300mm. Suited for small, light weight awning windows up to 1200mm wide by 1500mm high, it is capable of producing 250N of force operating a window up to 25kg in weight.

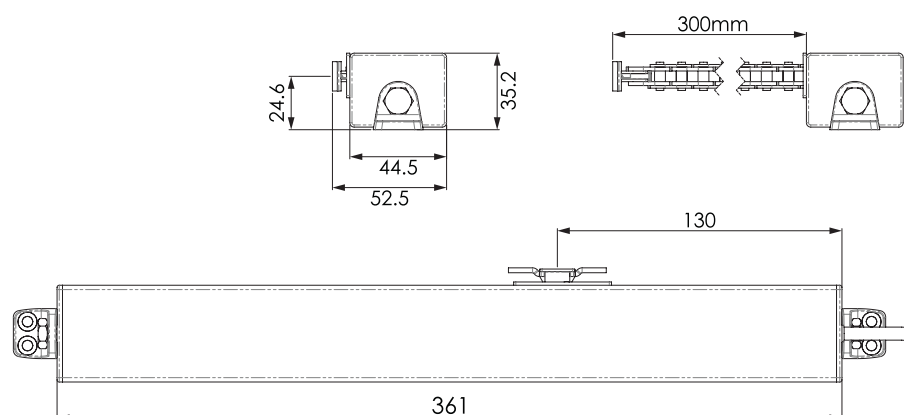

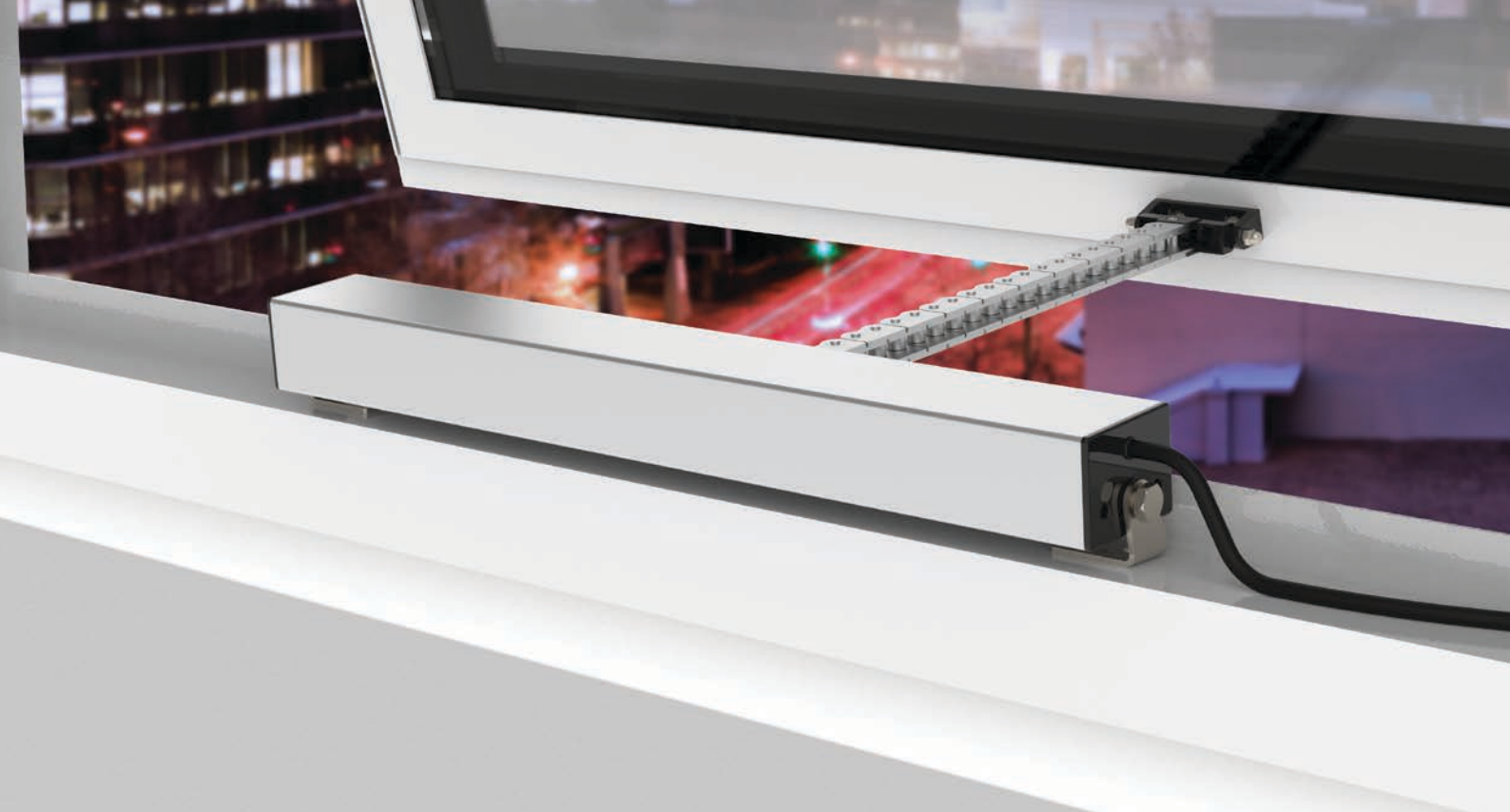

## LCD300 | LARGE SINGLE ELECTRIC CHAINWINDER

### PRODUCT DETAILS

<b>VOLTAGE</b>	24V DC
<b>PUSH/PULL FORCE</b>	400N
<b>CHAIN PROJECTION</b>	300mm
<b>WINDOW HEIGHT (MAX.)</b>	1800mm
<b>WINDOW WIDTH (MIN - MAX.)</b>	410mm - 1200mm
<b>CHAIN</b>	304 Stainless Steel
<b>CODE</b>	9050601 - LCD300

The Ventus LCD300 is a larger electric chainwinder featuring a 300mm chain projection and best suited for larger awning windows up to 1200mm wide by 1800mm high. Producing 400N of force, the electric chainwinder can operate a window up to 40kg in weight.

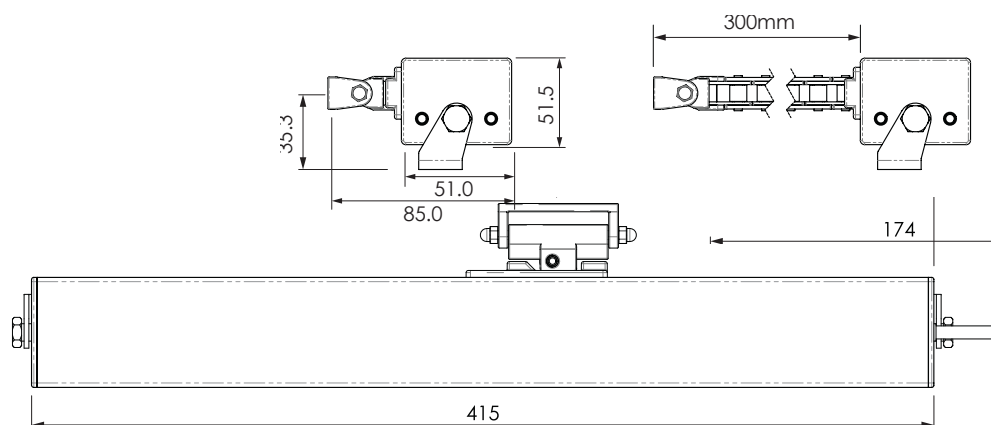



## TCE300 | TWIN ELECTRIC CHAINWINDER

### PRODUCT DETAILS

<b>VOLTAGE</b>	24V DC
<b>PUSH/PULL FORCE</b>	800N
<b>CHAIN PROJECTION</b>	300mm
<b>WINDOW HEIGHT (MAX.)</b>	1800mm
<b>WINDOW WIDTH (MIN - MAX.)</b>	850mm - 2400mm
<b>CHAIN</b>	304 Stainless Steel
<b>CODE</b>	9050600 - TCE300

The Ventus TCE300 is our twin chain electric winder featuring a dual 300mm chain projection. It offers operation for the largest windows measuring up to 2400mm wide by 1800mm high. The winder producing up to 800N of push/pull force is able to operate a window of up to 80kg in weight.

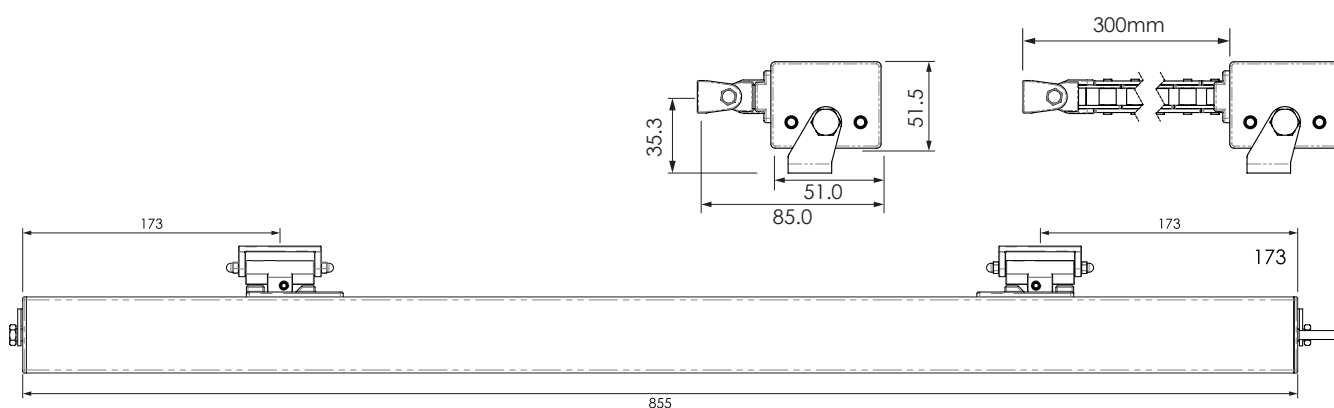



# ELECTRIC CHAINWINDER WIRING

## Chainwinder **Switch Unit**

Ventus chainwinders have an internal circuit board called a switch unit. This switch unit is not polarity sensitive, allowing the unit to run in either direction dependent on the signal sent and received.

+/- Runs open

-/+ Runs closed

If you press open on a remote or a BMS, the unit will receive a +/- signal to open the motor.

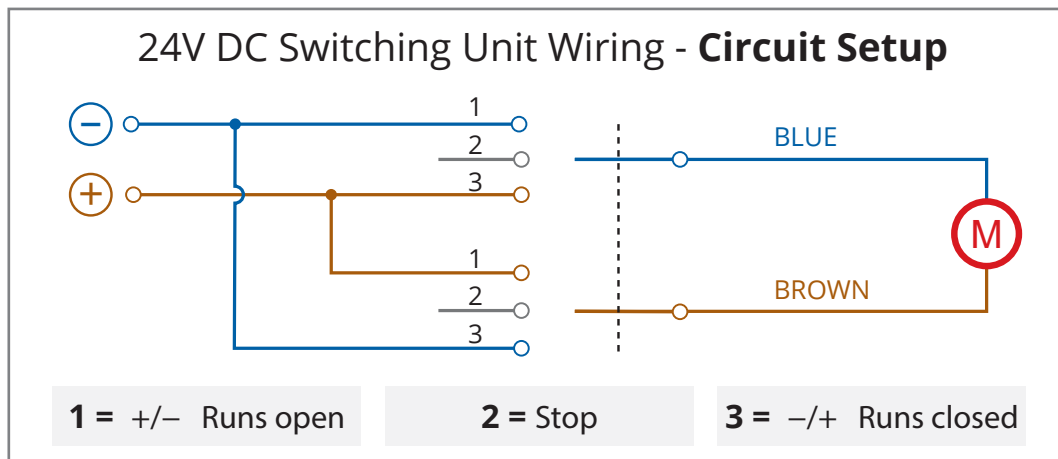

## Power **Supply**

**1 to 4 Motors:**  
2.5 Amp Power Pack



**5 to 8 Motors:**  
10 Amp Power Pack



## Peak Amp **Guide**

<b>SCE100s Standard Chain Electric</b>	- Peak Amp 1.0 Amp – Normal 0.4-0.6 Amp
<b>SCE300s Standard Chain Electric</b>	- Peak Amp 1.0 Amp – Normal 0.4-0.6 Amp
<b>LCD300 Large Chain Electric</b>	- Peak Amp 2.8 Amp – Normal 0.4-1.0 Amp
<b>TCE300 Twin Chain Electric</b>	- Peak Amp 5.6 Amp – Normal 0.8-2.0 Amp

### WIRING

The automation products operate off a 24V DC system and requires a minimum cable diameter of 0.75mm to reduce voltage loss over longer distances.

# SYNCHRONISING CHAINWINDERS

The Ventus Plug and Play system allows for a faster and more cost effective method of linking chainwinders together.

The Sync Lead guarantees that **both winders** will run in synchronisation. If a load related issue is detected, for example, one of the winders gets jammed or damaged, the protection circuit activates isolating the linked pair until the issue is resolved.

Ideally, the Sync Lead is fitted next to the controller allowing for ease of install, keeping the electrical components in one location.

Unlike other systems that use a network cable to achieve synchronisation, Ventus does not require additional components such as network adapters and does not require a separate power pack.

**Applicable only to:**  
**SCE100, SCE300 & LCD300**  
SCE300 + SCE300 Sync shown

**Important:** When using a Sync Lead, refer to the correct schematic to ensure you're using the correct power pack

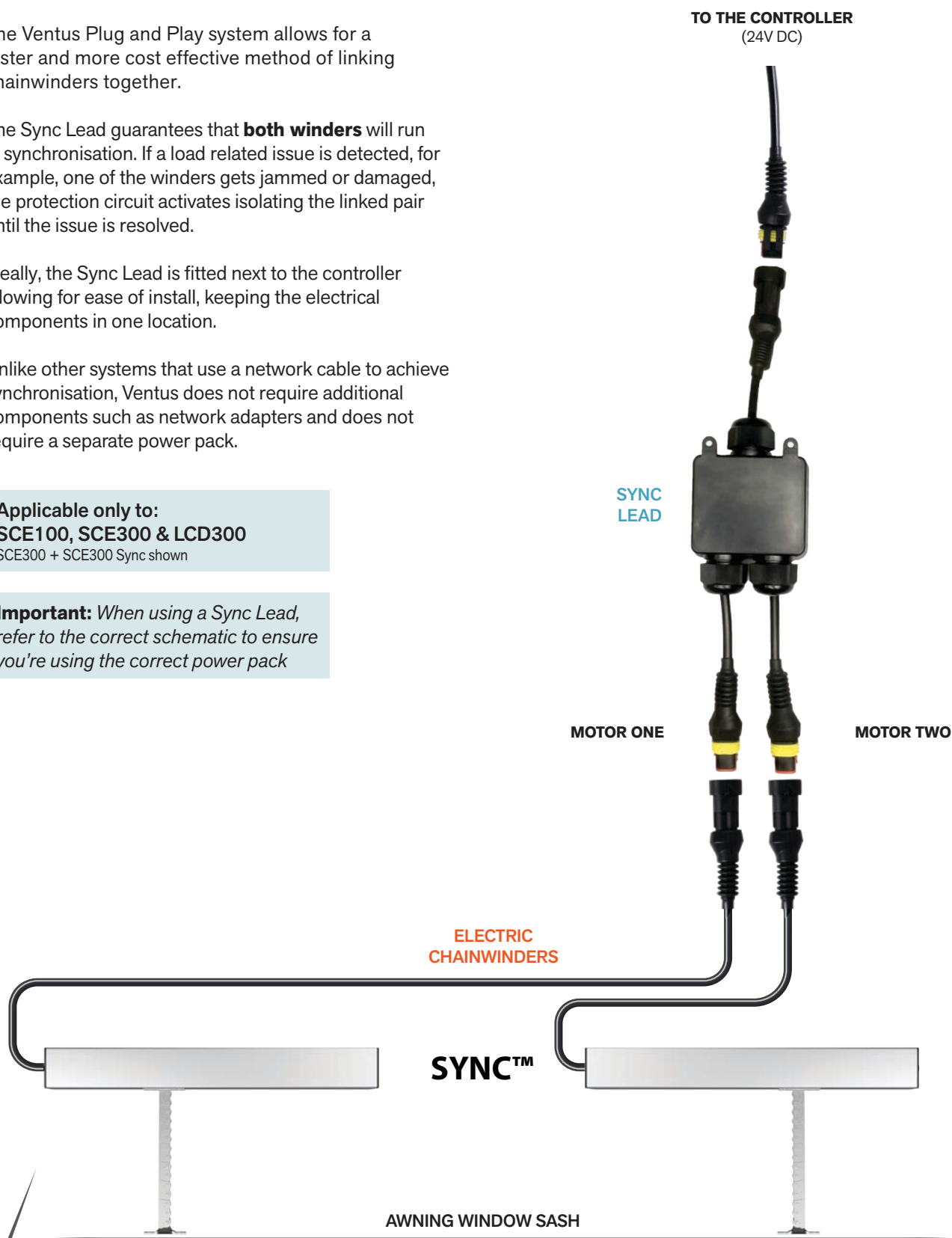



VENTUS\_AUTO\_HARDWARE\_2023 v1.5 - 18.09.2024